

MANTA RAY[®] MR-1

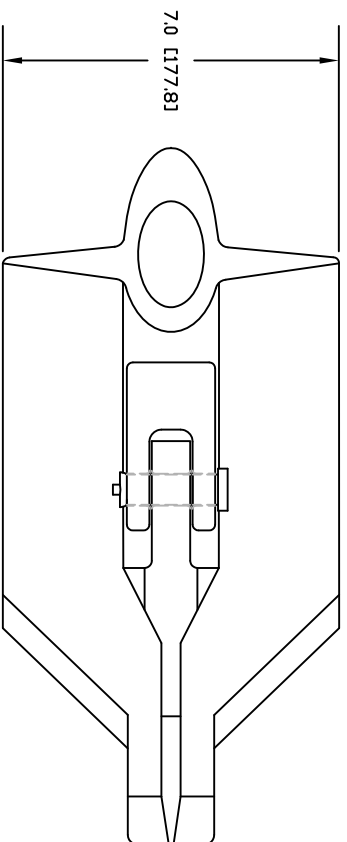

TOP VIEW

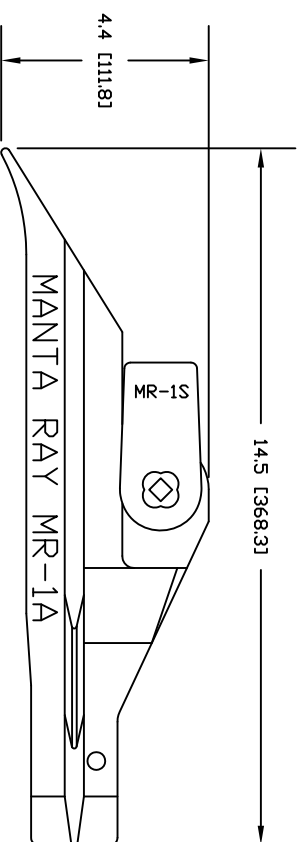

RIGHT SIDE VIEW

SPECIFICATIONS:

Size:

Width: 7.0 in [177.8 mm]
 Height: 4.4 in [111.8 mm]
 Length: 14.5 in [368.3 mm]

Weight:

12.8 lbs [5.8 kg]

Ultimate Strength:

40 kips [178 kN] (1 kip = 1,000 lbs)

Yield Strength:

30 kips [133 kN]

Maximum Working Load: (90% of Yield Strength)

Up to 27 kips [120 kN]

Soil Bearing Surface Area:

71 in² [458 cm²]

Type:

Impact driven soil anchor for tensile loads

Material:

Ductile Iron

Finish Specification:

Hot Dipped Galvanized ASTM A-123 OR BS729

Anchor Rods:

5/8 to 1 in [15 to 25mm]

Note: Anchors may be tapped to accept a variety of thread forms consistent with diameters above.

Typical Installation Depth

6 to 30 ft [2.1 to 9.1 m]

Holding Range:

Capacity Range: 7 to 25 kips [31 to 111 kN]

Soil Blow Count Range (SPT N): 10 to 20

Note: Refer to Foresight Products, LLC: Holding Capacities Chart for more information.



6430 East 49th Drive
 Commerce City, Colorado 80022
 Phone: 303-286-8955
 Fax: 303-287-3866
 Email: sales@earthanchor.com

MR-1 SPECIFICATIONS SHEET